



INSULATION ANCHOR ECO DRIVE W FOR WOOL

USAGE: Eco-Drive W is an innovative telescopic dowel with a screw-in metal nail for all base materials. It is suitable for use with the following insulation materials: mineral wool.

Anchor	Diameter (mm)	Length (mm)	Packaging (tk)
ECODRIVE W - 08150	8	150	100
ECODRIVE W - 08170	8	170	100
ECODRIVE W - 08190	8	190	100
ECODRIVE W - 08210	8	210	100
ECODRIVE W - 08230	8	230	100
ECODRIVE W - 08250	8	250	100
ECODRIVE W - 08270	8	270	100
ECODRIVE W - 08290	8	290	100
ECODRIVE W - 08310	8	310	100
ECODRIVE W - 08330	8	330	100
ECODRIVE W - 08350	8	350	100
ECODRIVE W - 08370	8	370	100
ECODRIVE W - 08390	8	390	100
ECODRIVE W - 08410	8	410	100
ECODRIVE W - 08430	8	430	100

BASE MATERIAL

A



CONCRETE, COLUMBIA KIVI

B



BRICK, SILICATE BRICK

C



HONEYCOMB BRICK

D



FIBO

E



ASH PANEL, BAUROC, AERATED CONCRETE

Parameter	Unit	Value
Anchor diameter	dk (mm)	8
Anchor plate diameter	Dk (mm)	110
Anchoring depth	hef (mm)	35/55
Drilling depth	ho (mm)	45/65
Thermal conductivity	X (W/K)	0,002
Anchor plate rigidity	S (KN/mm)	0,60
Base material	-	A B C D E
Anchor material	-	PA
Nail material	-	Carbon steel, glass-filled nylon coated head
Technical conformity	-	ETA - 13/0107

PRODUCT FEATURES AND ADVANTAGES



The screw-in telescopic dowel is particularly recommended for fragile materials to prevent damage to the base surface with a hammer. Eco-Drive W dowel ensures the best strength parameters and its installation is convenient and fast. A special EDST-W tool is required for installing the dowel.



Its telescopic design with a self-countersinking flange makes it the most modern fastener for areas that need to be covered with a tablet. Using this dowel helps to reduce the amount of mineral wool waste typically generated during drilling.

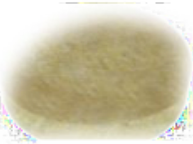

The dowel is supplied in an assembled form, so there is no need for separate assembly. The package also includes mineral wool tablets necessary for covering the installation points after the dowel's installation.

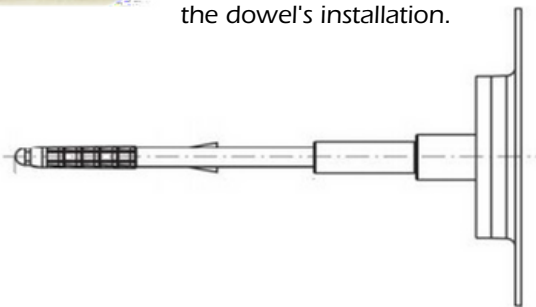

Effective anchoring depth range

Metal Nail Markings: Identification feature (S); Base surface categories (D E)



Anchor Markings: Identification feature (Wkret-Met); Anchor (WK THERM); Anchor diameter (8 x Lx); Base surface categories (A B C)

		New buildings		Old buildings	
		ttol adhesive mixture layer 8 mm		ttol adhesive mixture layer 8 mm + old plaster 20mm	
Code	dk x Lk [mm]	Category A B C D	Category E	Category A B C D	Packing
ECODRIVE W 08150	8 x 150	80	-	-	50
ECODRIVE W 08170	8 x 170	100	80	80	50
ECODRIVE W 08190	8 x 190	120	100	100	50
ECODRIVE W 08210	8 x 210	140	120	120	50
ECODRIVE W 08230	8 x 230	160	140	140	50
ECODRIVE W 08250	8 x 250	180	160	160	50
ECODRIVE W 08270	8 x 270	200	180	180	50
ECODRIVE W 08290	8 x 290	220	200	200	50
ECODRIVE W 08310	8 x 310	240	220	220	50
ECODRIVE W 08330	8 x 330	260	240	240	50
ECODRIVE W 08350	8 x 350	280	260	260	50
ECODRIVE W 08370	8 x 370	300	280	280	50
ECODRIVE W 08390	8 x 390	320	300	300	50
ECODRIVE W 08410	8 x 410	340	320	320	50
ECODRIVE W 08430	8 x 430	360	340	340	50

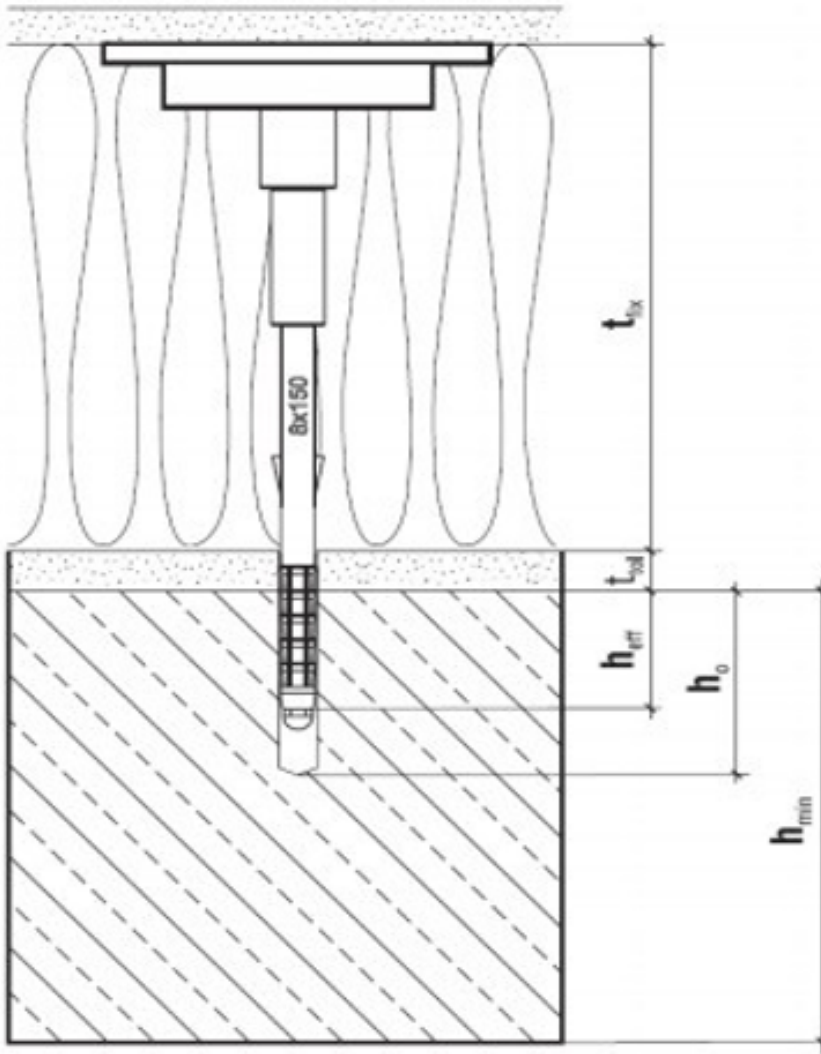

Anchor installation

INSULATION ANCHOR WK THERM SMART INSTALLATION GUIDE

Drill a hole into the base surface, with a diameter and depth in accordance with product specifications. Ensure that the drilling depth corresponds to the anchor length. Clean the hole of drilling residues. The anchors are to be hammered or screwed into the pre-drilled holes. Anchors should be installed such that the anchor plate is flush with the insulation material, with no protrusion. It is advisable to check for surface flatness after hammering/screwing in the anchors. In the case of too fresh adhesive, there's a risk that the anchor might turn a so far flat surface into a wavy one. We highly recommend using a router for inserting the anchors and covering the anchor head, either with a polystyrene or mineral wool corner thermal bridging.

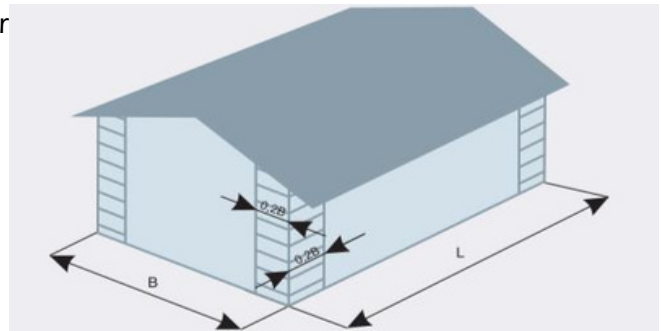

Correct installation of anchors is very important from the perspective of anchor performance. The location and installation of anchors should be determined on a project-specific basis. The consumption of anchors in different parts of the facade depends on:

- Wind load
- Building height
- Type of insulation material
- Base surface at least six anchors should be installed per square meter.
- It is advisable to use 20% more anchors in the corners of the building.
- The width of the corner zone is one fifth of the length of the shorter wall of the building.

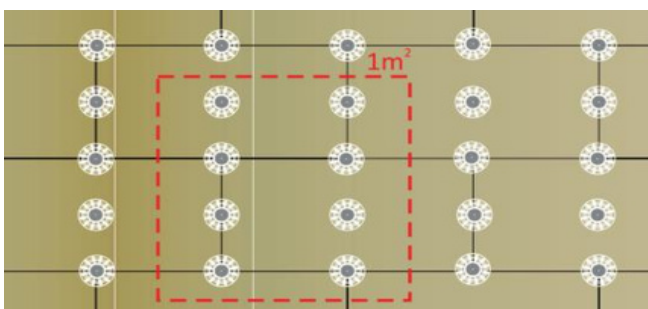
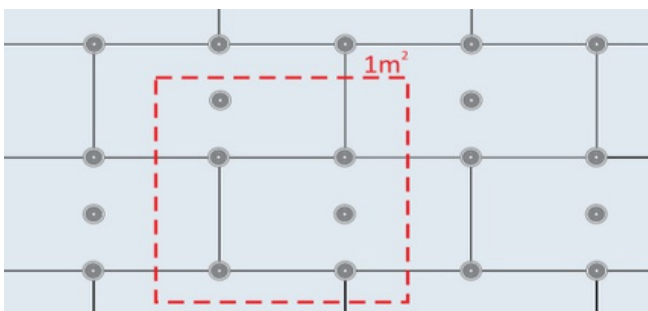

CENTRAL ZONE	CORNER ZONE
6tk/m ²	6tk/m ²
6tk/m ²	8tk/m ²
6tk/m ²	8tk/m ²
8tk/m ²	10tk/m ²
10tk/m ²	12tk/m ²
12tk/m ²	14tk/m ²
Insulation material:	
Polystyrene	Mineral wool